

Anchors for Aluminum Extrusions

Caster Kits for Doors / Assembly Fixtures / Drilling Jigs / Repair Pen

Anchors for Aluminum Extrusions



HFANK225 (Standard)

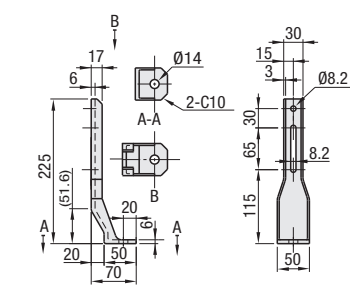

HFHANK8 (Heavy Type)

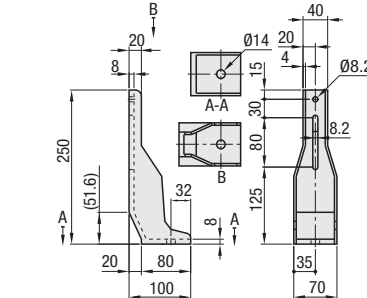

Ⓜ Sold as a single anchor.

RoHS

Ⓜ Material: EN 1.1158 Equiv. Ⓢ Surface Treatment: Black Baked Paint

| Part Number | Mass (g) | Extrusion (Series) | Screw, Nut | | Unit Price 1 ~ 9 pc(s) | Volume Discount Rate 10-50 |
|-------------|----------|--------------------|------------|-----------|---------------------------|-------------------------------|
| | | | Screw | Nut | | |
| HFANK225 | 577 | HFS6 | CBM6-14 | 3 HNTT6-6 | 3 | |
| | | HFS8 | CBM8-18 | 2 HNTT8-8 | 2 | |
| | | HFS8-45 | | | | |
| HFHANK8 | 1650 | HFS8 | CBM8-20 | 2 HNTT8-8 | 2 | |
| | | HFS8-45 | | | | |



Part Number
HFANK225
HFHANK8

EX Example

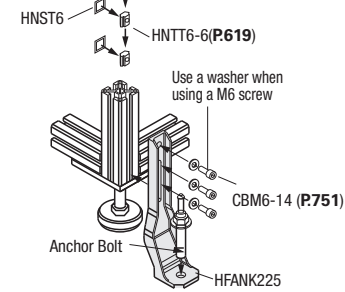

| Alteration | Code | Spec. | Extrusion (Series) | |
|-----------------------------------|------|--|--------------------|---------|
| | | | SET | SET2 |
| Set of applicable Screws and Nuts | SET | Set of screws and nuts to mount an anchor to an aluminum extrusion. Anchor bolts are not included. | HFS6 | HFS8-45 |
| | SET1 | | HFS6 | |
| | SET2 | | HFS8 | HFS8-45 |

* When SET1 is selected, three washers (WSSM12-6-1) are included.
Ⓜ When specifying -SET, -SET1 and -SET2, the product is not RoHS compliant.

Anchors for Aluminum Extrusions

HFSANK

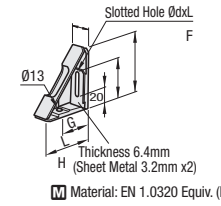

HFSANKW

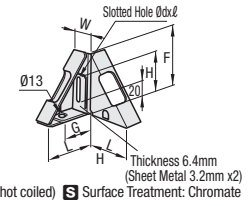

Ⓜ Material: EN 1.0320 Equiv. (hot coiled) Ⓢ Surface Treatment: Chromate

| Part Number | Type | No. | Mass (g) | Extrusion (Series) | Screw, Nut | | | H | F | G | W | L | d | ℓ | Unit Price 1 ~ 9 pc(s) | Volume Discount Rate 10-100 |
|-------------|------|------|----------|--------------------|------------|---------|----------|-----|----|----|------|------|----|----|---------------------------|--------------------------------|
| | | | | | Screw | Nut | Quantity | | | | | | | | | |
| HFSANK | 6 | 318 | HFS6 | CBM6-15 | 2 | HNTT6-6 | 2 | 100 | 60 | 40 | 30 | 86.5 | 7 | 40 | | |
| | 8 | 512 | HFS8* | CBM8-15 | | HNTT8-8 | | 120 | 80 | 50 | 40 | 96.5 | 10 | 60 | | |
| HFSANKW | 6 | 624 | HFS6 | CBM6-15 | 4 | HNTT6-6 | 4 | 100 | 60 | 40 | 33.2 | 86.5 | 7 | 40 | | |
| | 8 | 1020 | HFS8* | CBM8-15 | | HNTT8-8 | | 120 | 80 | 50 | 43.2 | 96.5 | 10 | 60 | | |

* Not applicable to HFS8-45.
Ⓜ Screws and nuts are not included.

Anchors for Aluminum Extrusions

HFDANK6

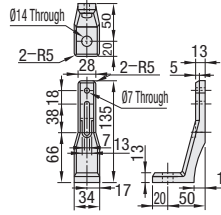

HFDANK8

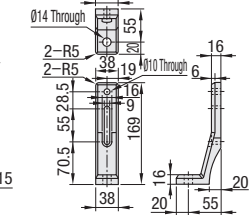

Ⓜ Material: EN AC-46100 Equiv.

| Part Number | Type | No. | Mass (g) | Extrusion (Series) | Screw, Nut | | Unit Price 1 ~ 9 pc(s) | Volume Discount Rate 10-100 |
|-------------|------|-----|----------|--------------------|------------|---------|---------------------------|--------------------------------|
| | | | | | Screw | Nut | | |
| HFDANK | 6 | 118 | HFS6 | CBM6-20 | 3 | HNTT6-6 | 3 | |
| | 8 | 147 | HFS8 | CBM8-28 | | HNTT8-8 | | |

* Not applicable to HFS8-45.
Ⓜ Screws and nuts are not included.



Part Number
HFDANK6



Part Number (SET, SST)
HFDANK6 SET

| Alteration | Code | Spec. | Applicable Anchor |
|-----------------------------------|---------------------------|---|--|
| Set of applicable Screws and Nuts | SET SST (Stainless Steel) | Set of screws and nuts to mount an anchor to an aluminum extrusion. Anchor bolts are not included. When SST is specified, screws and nuts will be in stainless steel. (Ex) Screw: SCB6-15, Nut: HNTTSM6-6 | HFSANK6 HFSANK8 HFSANKW6 HFSANKW8 HFDANK6 HFDANK8 |

Caster Kits for Doors



SQCM

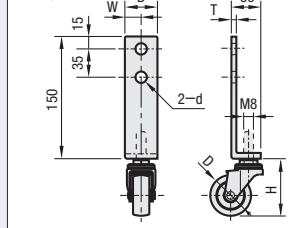

Ⓜ Material: Plate: EN 1.0038 Equiv. Trivalent Chromate
Caster: EN 1.0020 Equiv. (hot coiled)
Trivalent Chromate
Rubber Wheel

RoHS

Ordering Example
Part Number
SQCM6

| Part Number | Type | No. | Extrusion | Caster Allowable Load N | Mass (g) | Unit Price 1 ~ 9 pc(s) | Volume Discount Rate 10-20 |
|-------------|------|-----|-----------|-------------------------|----------|---------------------------|-------------------------------|
| | | | | | | | |
| | | 8 | 40 Square | | | | |

Ⓜ For orders larger than indicated quantity, please check with WOS.

| No. | Component | | | | | | | Unit Price 1-8 pc(s) | Volume Discount Rate 9-20 | | | |
|-----|-----------|----|---|------------------|-----|--------------------|----------|-------------------------|------------------------------|----------------|----------|-----|
| | Plate | | | Dedicated Caster | | Extrusion Mounting | | | | | | |
| | B | W | T | d | D | H | Quantity | | | Mounting Screw | Quantity | Nut |
| 6 | 30 | 15 | 6 | 7 | 8.5 | 50 | 68 | 1 | SCB6-14 | 2 | HNTT6-6 | 2 |
| 8 | 40 | 20 | 6 | 7 | 8.5 | 50 | 68 | 1 | SCB8-18 | 2 | HNTT8-8 | 2 |

Assembly Fixtures

HFZKG

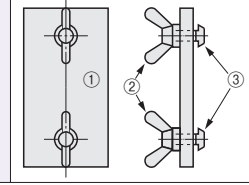

Ordering Example
Part Number
HFZKG6

| Part Number | Type | Extrusion (Series) | Component | | | | Unit Price 1-8 pc(s) | Volume Discount Rate 9-20 | |
|-------------|------|--------------------|-----------|----------|------------|----------|-------------------------|------------------------------|---------------------------|
| | | | Plate | Quantity | Wing Screw | Quantity | | | Post-Assembly Fitting Nut |
| HFZKG | 5 | HFS5 | HPTSS5 | 1 | CHOB4-8 | 2 | HNTFSN5-4 | 2 | |
| | 6 | HFS6 | HPTSS6 | 1 | CHOB6-12 | 2 | HNTFSN6-6 | 2 | |
| | 8-45 | HFS8-45 | HPTSS8-45 | 1 | CHOB8-15 | 2 | HNTFSN8-8 | 2 | |

Mount by straddling over two extrusions. By tightening the wing screw, the plane of the extrusion surface of (A) and (B) is made. Then (A) and (B) are connected with brackets.

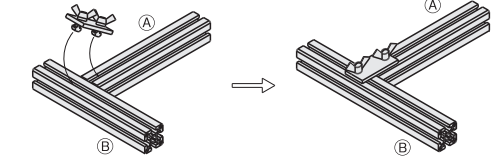

Drilling Jigs

Blind Joint D Hole / Wrench Hole Machining



HFSJG

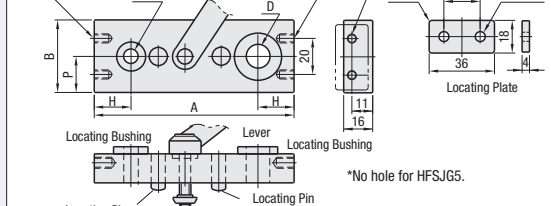

EX Example

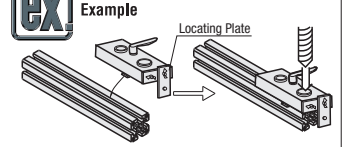

Ⓜ Material: EN 1.0038 Equiv.
Ⓢ Surface Treatment: Black Oxide

*No hole for HFSJG5.

- 1) Attach the Locating Plate to one of the holes on the Drilling Fixture.
- 2) Slide a drilling fixture into the extrusion channel up to the Locating Plate.
- 3) Drill a hole using the positioning jig bushing.

| Part Number | Type | No. | A | B | P | H | R | D | Extrusion (Series) | Component | | | Unit Price |
|-------------|------|-----|----|------|------|-----|------|---------|--------------------|-------------|-----------|-----|------------|
| | | | | | | | | | | Clamp Lever | Quantity | Nut | |
| HFSJG | 5 | 100 | 25 | 10 | 10 | 7.3 | 7.1 | HFS5 | CLDM5-20-Y | 1 | HNTTSN5-5 | 1 | |
| | 6 | 110 | 30 | 15 | 15 | 8 | 11.1 | HFS6 | CLDM6-20-M | 1 | HNTFSN6-6 | 2 | |
| | 8 | 110 | 40 | 20 | 20 | 8 | 13.1 | HFS8 | CLDM8-25-B | 1 | HNTFSN8-8 | 2 | 1 pc. |
| | 8-45 | 120 | 45 | 22.5 | 22.5 | 8 | 15.1 | HFS8-45 | CLDM8-25-S | 1 | HNTFSN8-8 | 2 | |

| Applicable Extrusion Series | H mm | H1 mm | D Type Hole mm | M Type Hole mm | d (Wrench Hole) mm |
|-----------------------------|------|-------|----------------|----------------|--------------------|
| HFS5 | 10 | 10 | - | 7.1 | 7.3 |
| HFS6 | 15 | 15 | 11.1 | 11.1 | |
| HFS8 | 20 | 20 | 13.1 | 13.1 | 8 |
| HFS8-45 | 22.5 | 20 | 15.1 | 13.1 | |

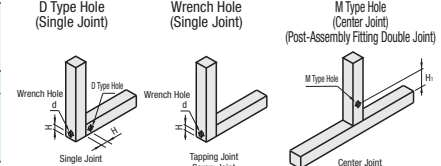

Ordering Example
Part Number
HFSJG6

Black Anodize Spot Repair Pen



| Part Number | Volume (ml) | Type | Features | Color | Usage | Operating Temp. Range (°C) | How to Use / Dry Condition | Main Component | Unit Price 1 ~ 9 pc(s) | Volume Discount Rate 10-50 |
|-------------|-------------|------|--|-----------|--|----------------------------|---|----------------|---------------------------|-------------------------------|
| | 13 | Pen | A felt-tipped pen that can quickly repair flaws on black anodized items. Repairs become less noticeable as the color is similar to that of black anodized aluminum extrusions. | Mat Black | Flaw repairs of black anodized type on aluminum extrusions. Marking on extrusions. | 5-35 | Shake well before use, and directly apply on the surface to repair. | Acrylic Resin | | |

Ordering Example
Part Number

RoHS